

01

GDXQ/D 新能源锂电专用泵

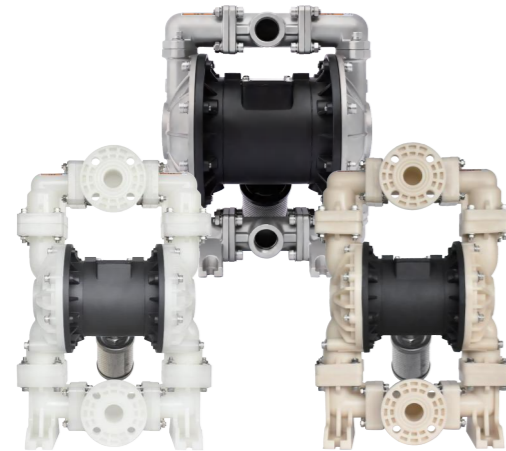

GDXQ-25 不锈钢/塑料/氟塑料



性能曲线图

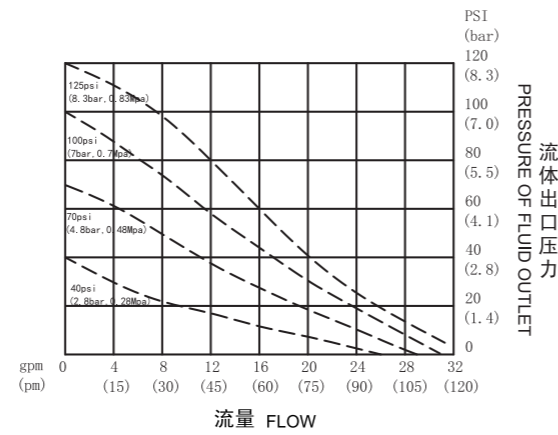

规格参数

最大工作流量 Max. Flow	31 gpm (116 lpm)	最大虹吸高度 (干抽或湿抽) Max.Suction Height (dry suction or wet suction)	18 ft. (5.48 m)
最大工作压力 Max. Working Pressure	120 psi (0.84 Mpa, 8.4 bar)	最大输送固体颗粒 Max. Permitted Grain	1/8 in. (3.2 mm)
流体进口尺寸 Fluid Inlet Size	1 in. bsp (f)	每往复流量 Every Reciprocating Flow	0.15 gal. (0.57 L)
流体出口尺寸 Fluid Outlet Size	1 in. bsp (f)	最大往复速度 Max. Reciprocating Speed	276 cpm
空气进口尺寸 Air Inlet Size	1/2 in. bsp (f)		

安装尺寸图

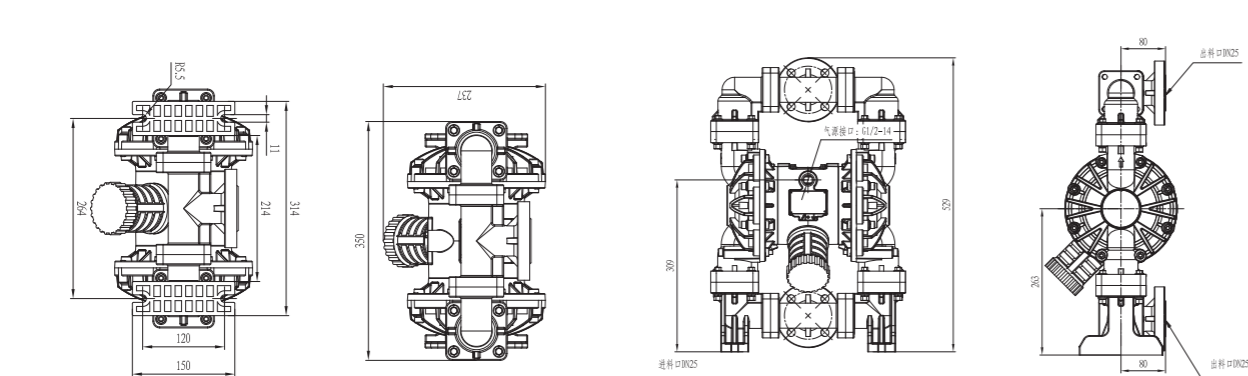
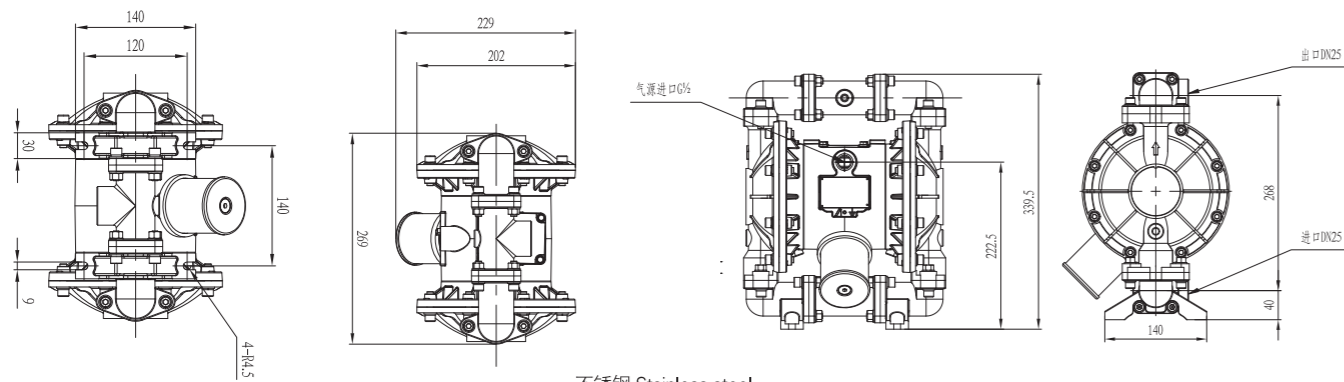

GDXQ-40 不锈钢/塑料/氟塑料

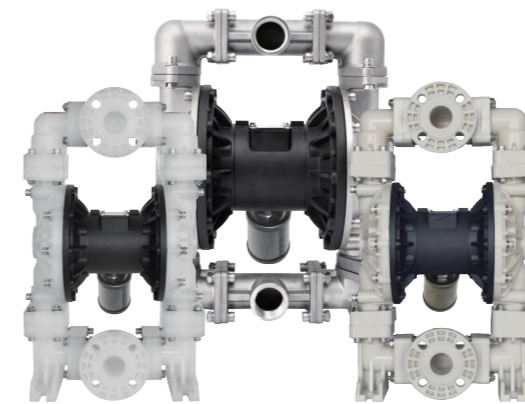

性能曲线图

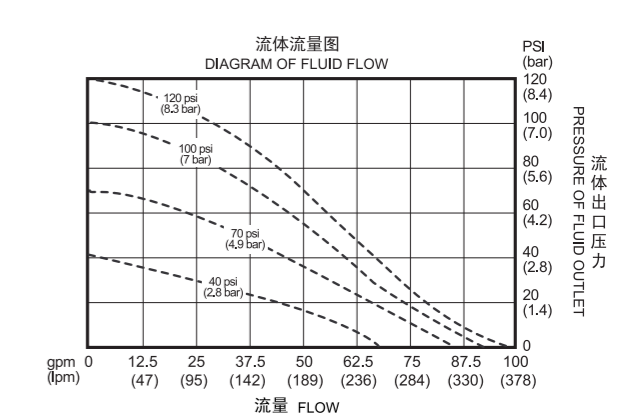

规格参数

最大工作流量 Max. Flow	100 gpm (378.5 lpm)	最大虹吸高度 (干抽或湿抽) Max.Suction Height (dry suction or wet suction)	18 ft. (5.48 m)
最大工作压力 Max. Working Pressure	120 psi (0.84 Mpa, 8.4 bar)	最大输送固体颗粒 Max. Permitted Grain	3/16 in. (4.8 mm)
流体进口尺寸 Fluid Inlet Size	1-1/2 in. bsp (f)	每往复流量 Every Reciprocating Flow	0.5 gal. (1.9 L)
流体出口尺寸 Fluid Outlet Size	1-1/2 in. bsp (f)	最大往复速度 Max. Reciprocating Speed	200 cpm
空气进口尺寸 Air Inlet Size	1/2 in. bsp (f)		

安装尺寸图

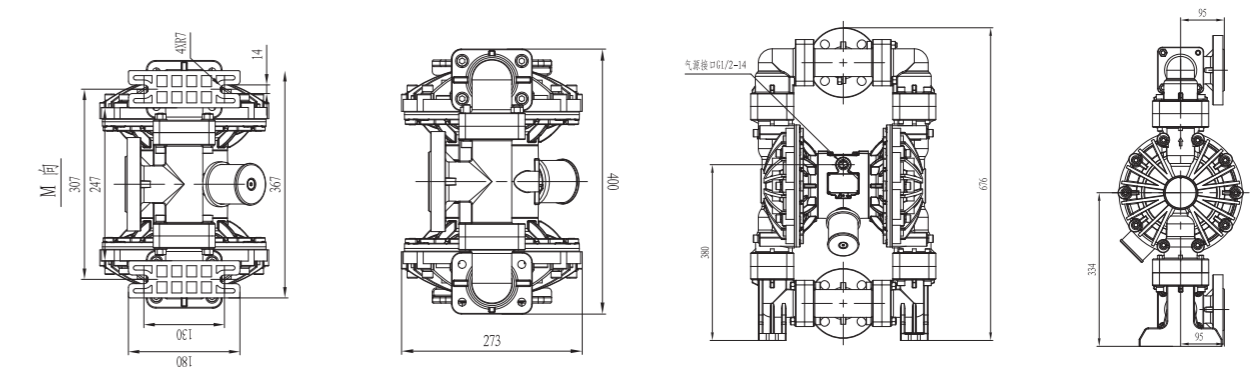
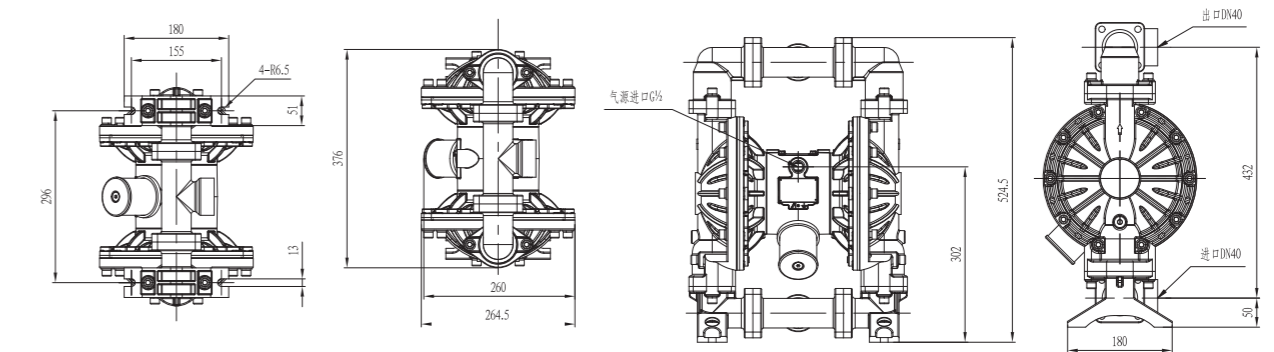

GDXQ-50 不锈钢/塑料/氟塑料



性能曲线图

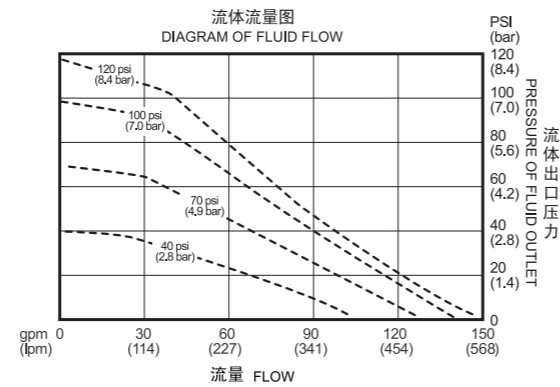

规格参数

最大工作流量 Max. Flow	150 gpm (568 lpm)	最大虹吸高度 (干抽或湿抽) Max.Suction Height (dry suction or wet suction)	18 ft. (5.48 m)
最大工作压力 Max. Working Pressure	120 psi (0.84 Mpa, 8.4 bar)	最大输送固体颗粒 Max. Permitted Grain	1/4 in. (6.4 mm)
流体进口尺寸 Fluid Inlet Size	2 in. bsp (f)	每往复流量 Every Reciprocating Flow	1.03 gal. (3.90 L)
流体出口尺寸 Fluid Outlet Size	2 in. bsp (f)	最大往复速度 Max. Reciprocating Speed	145 cpm
空气进口尺寸 Air Inlet Size	1/2 in. bsp (f)		

安装尺寸图

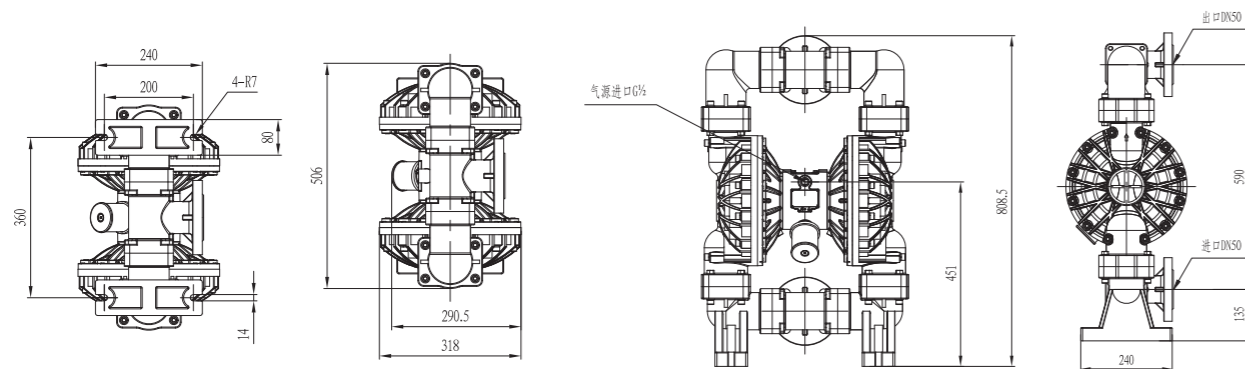
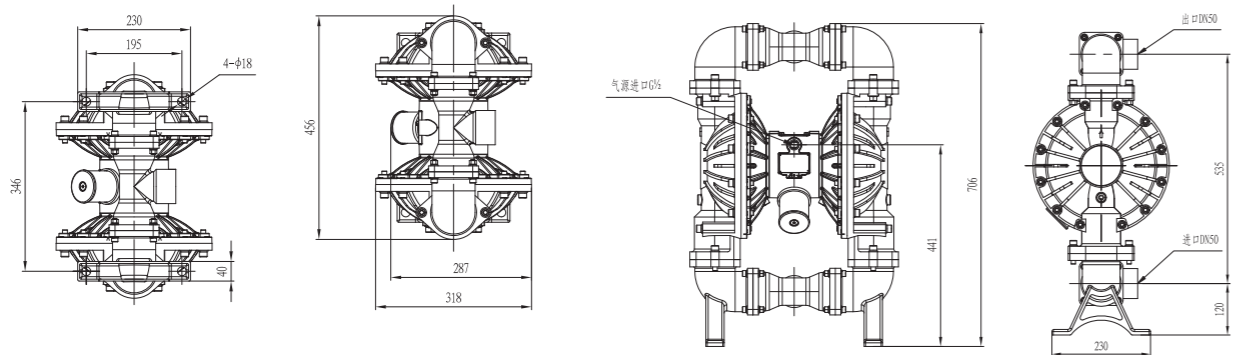

GDXQ-80 不锈钢/塑料/氟塑料

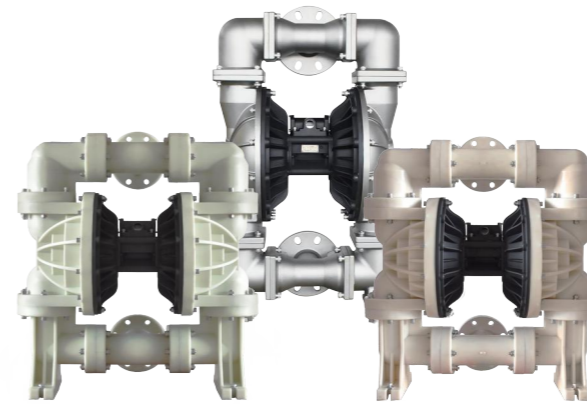

性能曲线图

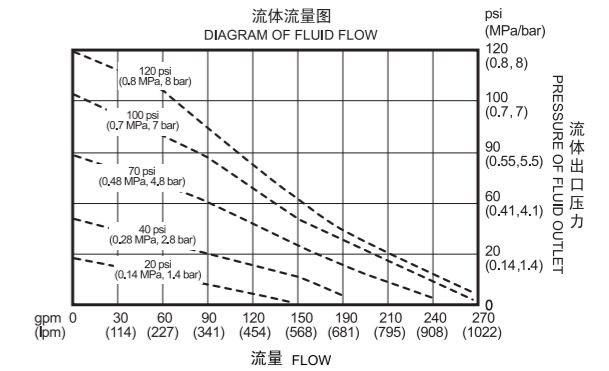

规格参数

最大工作流量 Max. Flow	275 gpm (1041 lpm)	最大虹吸高度 (干抽或湿抽) Max.Suction Height (dry suction or wet suction)	25 ft. (7.6 m)
最大工作压力 Max. Working Pressure	120 psi (0.84 Mpa, 8.4 bar)	最大输送固体颗粒 Max. Permitted Grain	3/8 in. (9.4 mm)
流体进口尺寸 Fluid Inlet Size	3 in. bsp (f)	每往复流量 Every Reciprocating Flow	2.0 gal. (7.6 L)
流体出口尺寸 Fluid Outlet Size	3 in. bsp (f)	最大往复速度 Max. Reciprocating Speed	135 cpm
空气进口尺寸 Air Inlet Size	3/4 in. bsp (f)		

安装尺寸图

